

REV A

CHROMA-Q INSPIRE TERMINAL STRIP

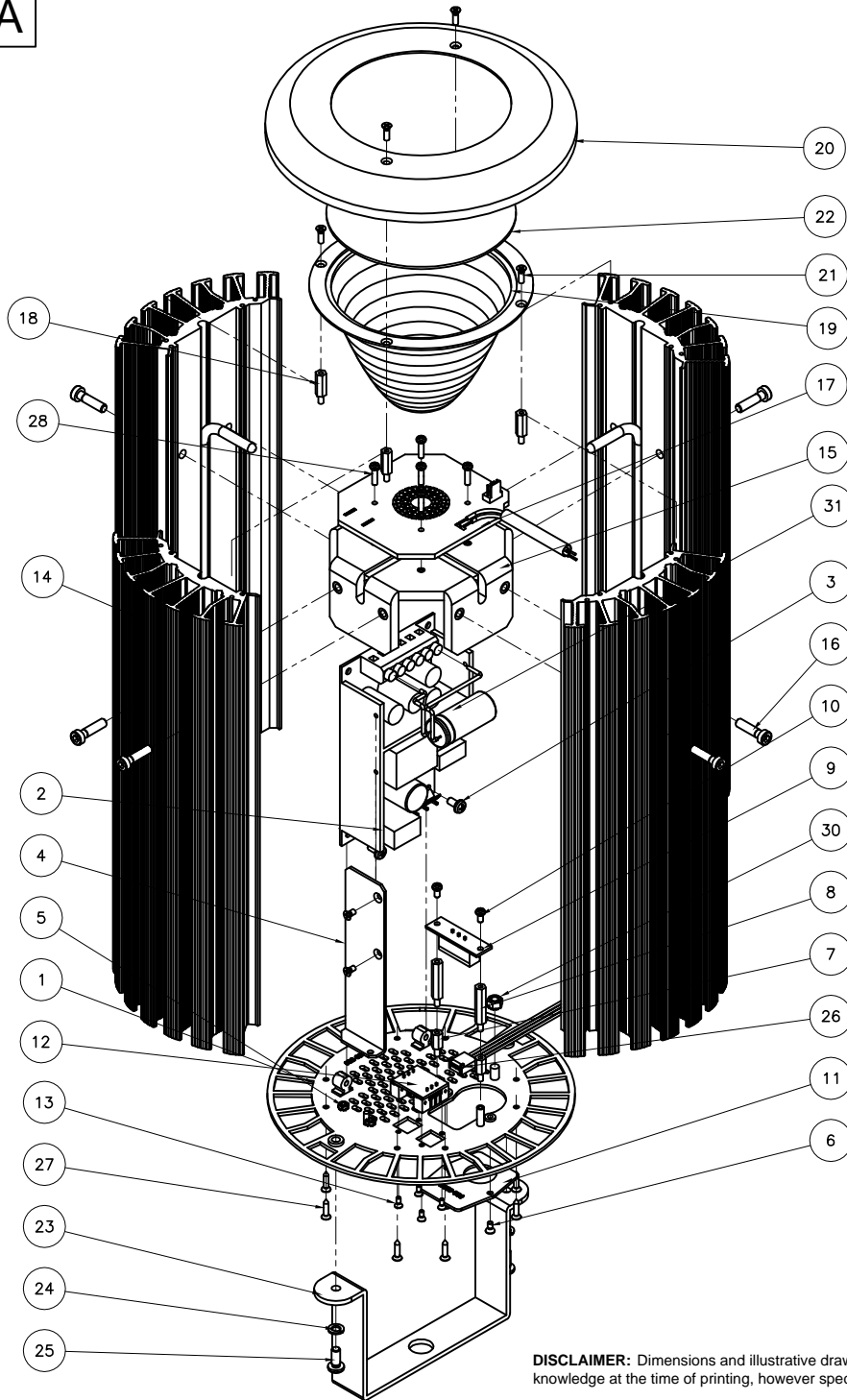

NOTE:

- LENS DEPENDING ON THE UNIT TYPE:
NARROW 631-0021
MEDIUM 631-0022

DISCLAIMER: Dimensions and illustrative drawings contained herein are accurate to the company's knowledge at the time of printing, however specifications are subject to change without notice

31	HARNES CAPACITOR NOISE	632-0302	1
30	NUT HEX M5 COMBI Zn	450-3205-1	1
29	FERRITE CLAMP-ON 6.76mm	900-2135	1
28	SCREW M3x12 PH PLPS Blk	430-1212-0	5
27	SCREW SELF TAP FH PZDV BLK ST2.9x13	429-6113-9	8
26	JUMPER 4PIN 15"	631-0046	1
25	SCREW M5x12 PH PLPS BLK	450-1212-0	2
24	WASHER LOCK M5	450-2809-4	2
23	BRACKET HANDLE HOUSE LIGHT	631-0005	1
22	LENS NARROW, MEDIUM OR WIDE	LENS	1
21	SCREW M3x10 FH PLPS BLK	430-1110-0	4
20	CAP HOUSE LIGHT BLACK ANODIZED	632-0506	1
19	REFLECTOR PARABOLIC COATED	632-0505	1
18	STDOFF M-F M3x15x7, 6mm STUD	430-4115-1	4
17	PCB COMPLETE LED INSPIRE EXT CTRL	632-0104	1
16	SCREW M5x20 SHCS ST	450-1420-4	8
15	BRACKET PCB SUPPORT HEAT PIPE	632-0001	1
14	S/A EXTRUSION W/ HEAT PIPE	632-0502	4
13	SCREW M2.5x6 FH PLPS BLK	425-1106-0	4
12	PCB COMPLETE DMX IN/OUT	632-0107	1
11	PLATE CLOSING POWER	632-0007	1
10	SCREW M3x6 PH PLPS Blk	430-1206-0	2
9	PCB FILLED HOUSE LIGHT MAINS	632-0106	1
8	STDOFF M-F M3x25x7, 6mm STUD	430-4125-1	2
7	STDOFF M-F M3x10x7, 6mm STUD	430-4110-1	2
6	SCREW M3x6 FH PLPS Blk	430-1106-0	4
5	NUT HEX M3 COMBI Blk	430-3203-0	2
4	BRACKET SUPPORT PSU	632-0006	1
3	SCREW M4x8 PH PLPS BLK	440-1208-0	2
2	POWER SUPPLY 24V 150W SCREW TERM	900-2061	1
1	BACK PLATE INSPIRE NO ADDRESSING	632-0005	1
ITEM	DESCRIPTION	PART#	QTY
Parts List			